

# **Tru-Tube**<sup>®</sup>

AUGER STRAIGHTENER

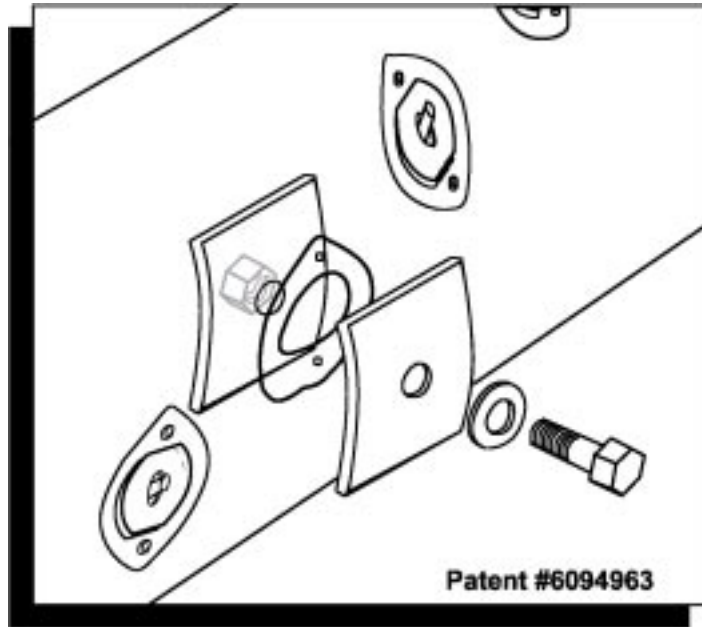

## Auger Tube Repair Instructions

Poly Tech Industries, Inc.  
PO Drawer 349  
Monticello, GA 31064  
800.542.7659

Tru-Tube is a Registered Trademark of Hoffman Farms

## Introduction

The Tru-Tube auger straightening kit consists of the four items illustrated. In addition to the tools required to service the implement, a 1 1/8" ratchet wrench is required to operate the straightening tools. It is not necessary to remove the auger assembly from the implement. Repairs are made through the nearest inspection cover/hole to the damaged area.



## Safety Precautions

**THERE ARE INHERENT HAZARDS ASSOCIATED WITH THE SERVICE AND REPAIR OF IMPLEMENTS AND FOR USING THIS TOOL.**

FOR YOUR SAFETY:

Raise header and lock header cylinders in up position by means provided by manufacturer.

Raise reel and lock reel cylinders in up position by means provided by manufacturer.

Turn off all power, remove ignition key and keep it in your possession.

Always wear eye protection when servicing the implement and using the Tru-Tube tools.

Wear work gloves to work with and handle damaged equipment which may have torn or sharp metal edges.

## Repair Operation

Remove inspection cover nearest the damaged finger(s).

Dissassemble the damaged finger from the crankshaft running through the auger tube and remove the finger assembly. Remove the finger bearing guide from the tube. Inspect these components for damage and replace the failed parts with new ones.



Hold the inside straightening pad over the damaged hole on the inside of the tube. Place the 3/4"-10 x 2 hex head bolt with 3/4" flat washer through the hole of the outside straightening pad as illustrated. Guide the bolt through the damaged auger tube hole and thread finger tight into the inner pad.

Use one hand through the inspection hole to position the inner straightening pad over the center of the damaged area and the other hand to operate the ratchet wrench and slowly tighten the 3/4" bolt.

**IMPORTANT:** Keep the threads of the weld nut on the inner pad lubricated during storage and when using it. This will reduce thread friction and the tendency for the pad to rotate while tightening the bolt.

Be sure that the pads remain centered on the damaged area. If they shift, loosen the bolt enough to shift the pads back over the hole.

Completely tighten the bolt until the tube is straight.

Loosen and remove the straightening tools and install the new finger bearing guide, finger, and other parts as required.

# **Tell a Friend About Tru-tube!**

**The Tru-tube Auger Straightener is  
available for 12", 14" and 16" augers.**



**800.542.7659**

[www.polyskid.com](http://www.polyskid.com)